

REGIONAL DISTRICT OF NANAIMO – INTERACTIVE WEB MAP

Explanation of Map Layout, Tools and Searches.

October 2015

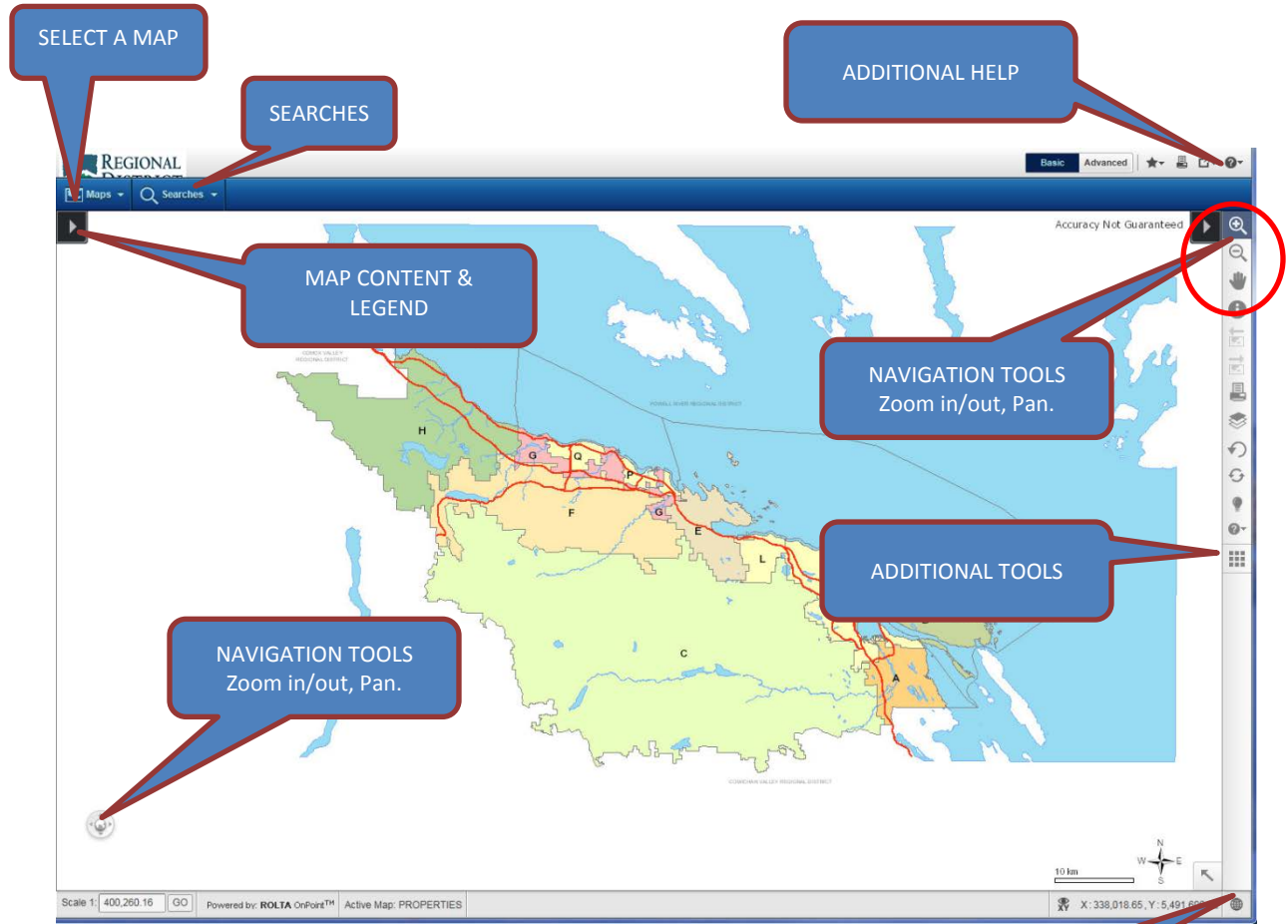

SELECT A MAP:

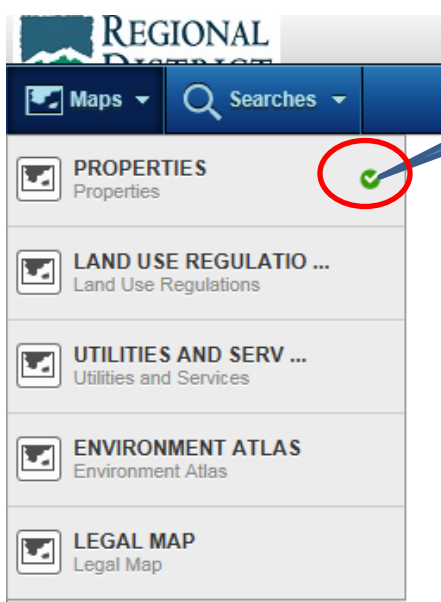

CURRENT MAP

SWITCH BETWEEN UTM & LAT LONG COORDINATES

Properties – Basic Property Layers (Lots, Addresses, Roads, Parks, Air Photos, Simple Topography.)

Land Use Regs. – Basic Layers plus layers that relate to Property Development (Zones, OCP, Development Permit Areas, sensitive areas etc.)

Utilities & Services – Basic Layers plus RDN Service Areas (Water, Sewer, Fire etc.)

Environment Atlas – Basic Layers plus Environmentally Sensitive Layers (SEI, Watercourses)

Legal Map – Conventional Cadastral Map (property and easement plan references with text)

MAP CONTENT: List of Layers in the Current Map (Turn layers ON/OFF, Set Active Layer)

Click to Access Map Content

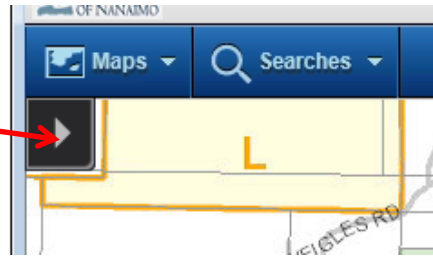

Layers Legend

Active Layer:

Properties Base Map

- Bcgs 5000 map...
- Highways
- Address Text
- Address Point
- Driveways
- Parcels**
- District lots blo...
- Roads
- RDN Electoral...
- Electoral areas...
- TRIM Contours...
- Watercourses
- Lakes and ocean

Click in box to Turn Layers ON/OFF

SELECT ACTIVE LAYER
Use with the Identify Tool to show information about a feature in the Layer.
Default is Parcels

CURRENT ACTIVE LAYER

SEARCHES: Simple Searches - In most cases a property can be found by the Address, the PID (property ID assigned by Land Titles) or Folio (assigned by BC Assessment Authority).

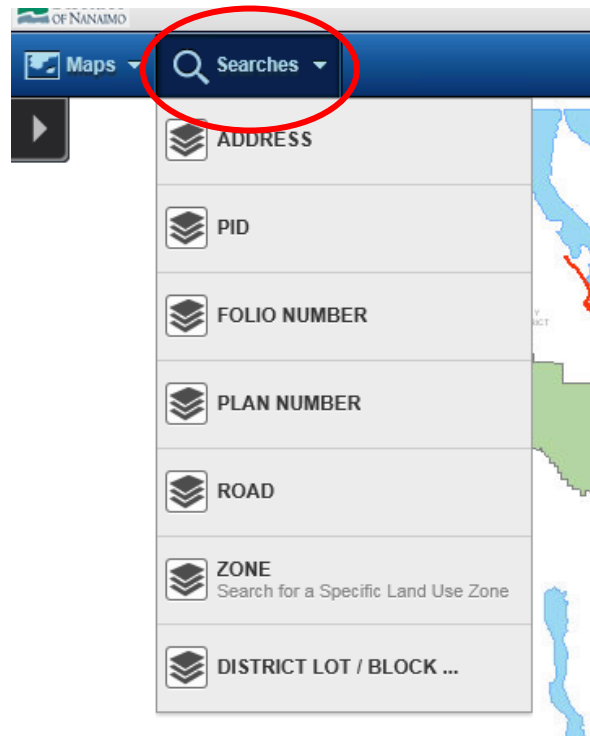

Instructions and Tips are displayed on each Search window.
Here are some additional notes:

ADDRESS Search – the road name is not necessary for the search. It is simpler to search just on the address number. The **Look Up** tool will return a list of all addresses that match your entry. **Select** from the list and click **'Search'**. Note that the map does not include addresses inside Nanaimo, Parksville or Qualicum Beach.

PID Search – Omit any spaces, dashes or other separators.

FOLIO Search – Our formatting includes an extra '0' after the jurisdiction number. You may omit the jurisdiction and 0 from your entry. Eg 10439.020 instead of 769010439.020. The **Look Up** tool will find all matching folios. **Select** one from the dropdown list and click **'Search'**.

ROAD Search – This searches for the road centerline and includes municipal roads. Only enter the first few letters of the road name and use **Look Up** to provide a pick list. Eg 'ced' will return CEDAR RD, CEDAR RIDGE PL, CEDAR PL etc. **Select** one from the dropdown list and click **'Search'**.

PLAN NUMBER Search – Enter the numbers only, the **Look Up** will add the prefixes VIP, VIS, EPP or EPS and provide a pick list. The **Search** button will zoom the map to display all lots in the plan. In cases of large plans containing many lots, results may be confusing so other Search options should be tried.

ZONE Search – This provides a search for chosen Land Use Zones within the RDN Electoral Areas. Electoral Area F is covered by By Law 1285. All other areas except Elect B is covered by By Law 500. For information on Zoning in Electoral Area B go to Islands Trust. (www.islandstrust.bc.ca)

To action the Search – Use the pick list to select the **Bylaw** and then the **Zone**.

Click the **Search** button.

The map will zoom to display all the results and a list/report will also appear. If there are several results, you may use the navigation tools to pan and zoom to view areas in more detail. Below the map, a report will appear that displays a line for each selected zone shape.

The Gearwheel Tool provides options to Zoom to, Clear or Show on Map. Blue hyperlinks open additional details on Zones and Subdivision Districts.

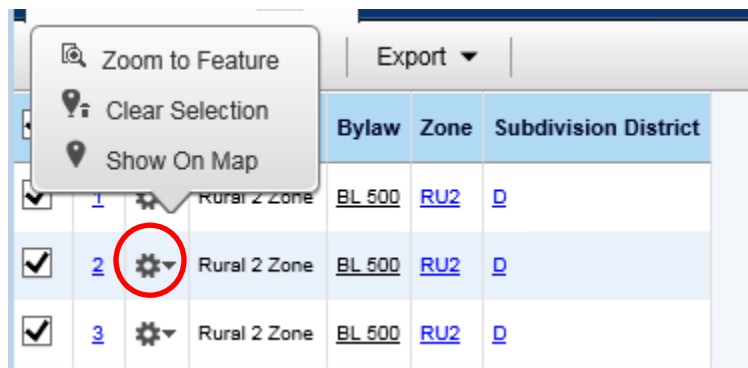

NAVIGATION:

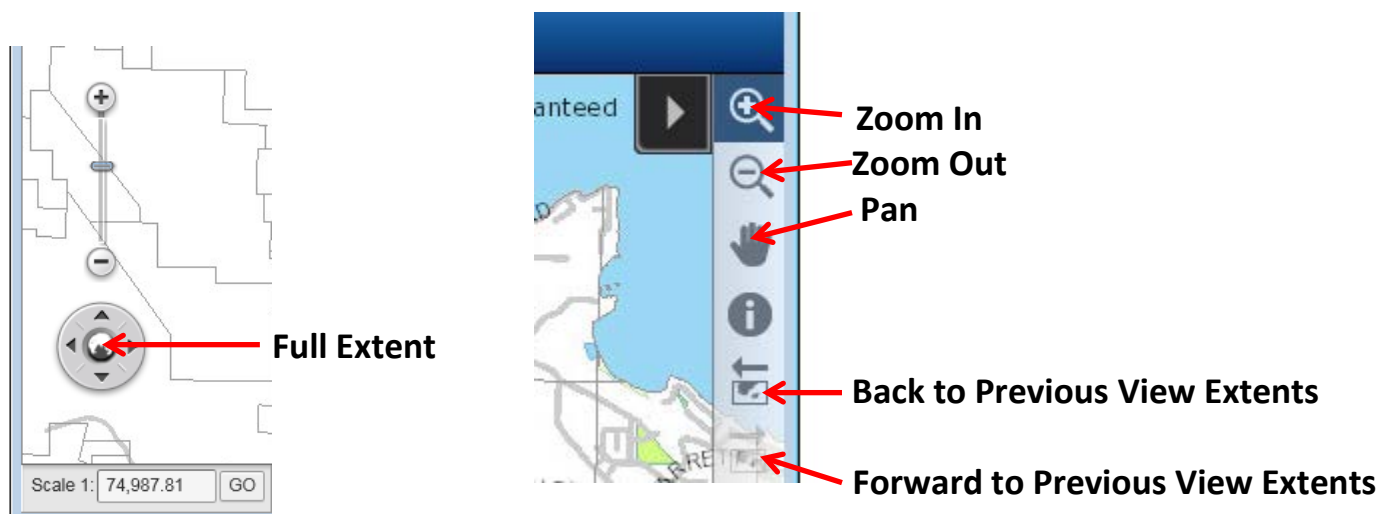

Activate a tool by clicking on the icon.

The **Zoom In/Out** tools can be applied by a single click in the map or by a click, drag and release that creates a box which controls the location and degree of zoom.

Pan around the map by a click and drag action.

GETTING INFORMATION:

Most layers in each map have information (attributes) attached to each shape contained in the layer. eg the **Parcels** have legal description attributes and **Zoning** has the Bylaw, and Zone name and a link to a definition of the zone (see below for instructions).

Click on the 'Identify' icon  to make it active and then click inside the shape.

The 'More Information' window will appear

Select the layer from the pick list

Attributes

Expand 'Grouped Attributes' and 'Assessment Values' for more details

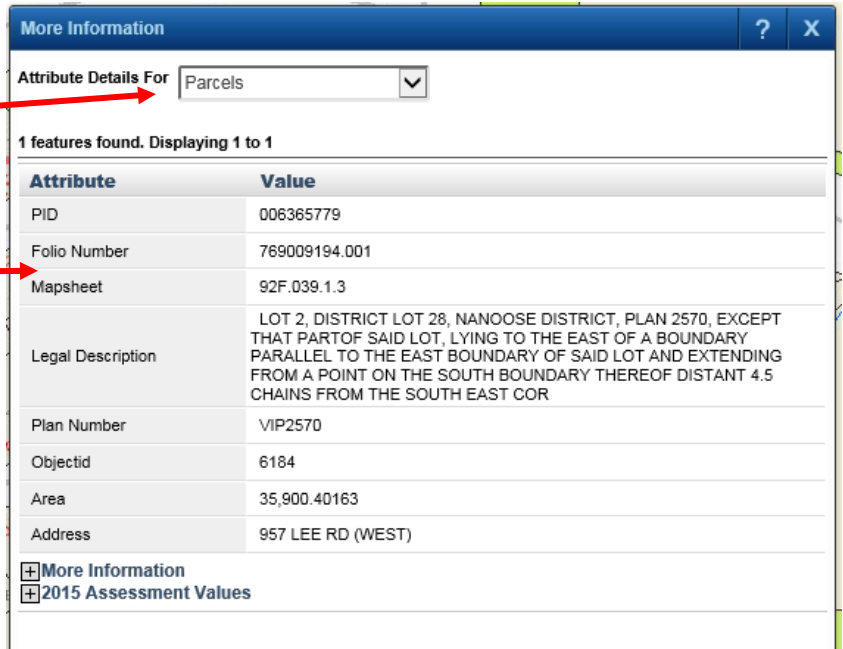

The screenshot shows a 'More Information' window with a dropdown menu set to 'Parcels'. Below the dropdown, it states '1 features found. Displaying 1 to 1'. A table lists attributes and their values:

Attribute	Value
PID	006365779
Folio Number	769009194.001
Mapsheet	92F.039.1.3
Legal Description	LOT 2, DISTRICT LOT 28, NANOOSE DISTRICT, PLAN 2570, EXCEPT THAT PART OF SAID LOT, LYING TO THE EAST OF A BOUNDARY PARALLEL TO THE EAST BOUNDARY OF SAID LOT AND EXTENDING FROM A POINT ON THE SOUTH BOUNDARY THEREOF DISTANT 4.5 CHAINS FROM THE SOUTH EAST COR
Plan Number	VIP2570
Objectid	6184
Area	35,900.40163
Address	957 LEE RD (WEST)

At the bottom of the window, there are expandable sections: '+ More Information' and '+ 2015 Assessment Values'.

SEE NEXT PAGE FOR HOW TO GET ZONE INFORMATION

GETTING ZONE INFORMATION:

Find the target property using the Search Tools.

1. Go to the 'Land Use Regulations' Map.
2. Make the 'Identify' tool active.
3. Click inside the Property or Zone shape. (Zone shapes have a red outline)
4. Select 'Zones' from the pick list.
5. The attributes will display the Bylaw number and the Zone and Subdivision District.
6. The [blue](#) attribute is a hyperlink that will open a pdf page that contains details on the Zone.

Section 3.4.41

PUBLIC 1 PU1

Permitted Uses and Minimum Site Area

Required Site Area with:

Permitted Uses	Community Water & Sewer System	Community Water System	No Community Services
a) Personal Care	4000 m ²	5000 m ²	8000 m ²
b) Personal Care Unit	400 m ²	1600 m ²	1.0 ha
c) Public Assembly Use	4000 m ²	5000 m ²	8000 m ²
d) Public Utility Use	500 m ²	1000 m ²	1500 m ²
e) Residential Use ¹	n/a	n/a	n/a
f) School	4000 m ²	5000 m ²	8000 m ²

Notwithstanding the provisions outlined above, the following Accessory Use shall be permitted in conjunction with a school for the parcel legally described as Lot A, District Lot 7, Bright District, Plan 30903:
School Accomodation, as defined in this zone².

Other Advanced Tools are available in the ToolBar and above the map window.

Tips on their use are provided in each Tool Window.

More generic on-line help can be accessed from the '?' icon:

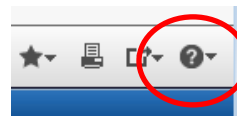

For more assistance contact the RDN GIS Dept:
250 390 4111 or 1 877 607 4111 or gis@rdn.bc.ca

BE ADVISED TO CONTACT THE REGIONAL DISTRICT OFFICE BEFORE TAKING ANY ACTION BASED ON INFORMATION PROVIDED IN THE MAP.